

AWAFAST

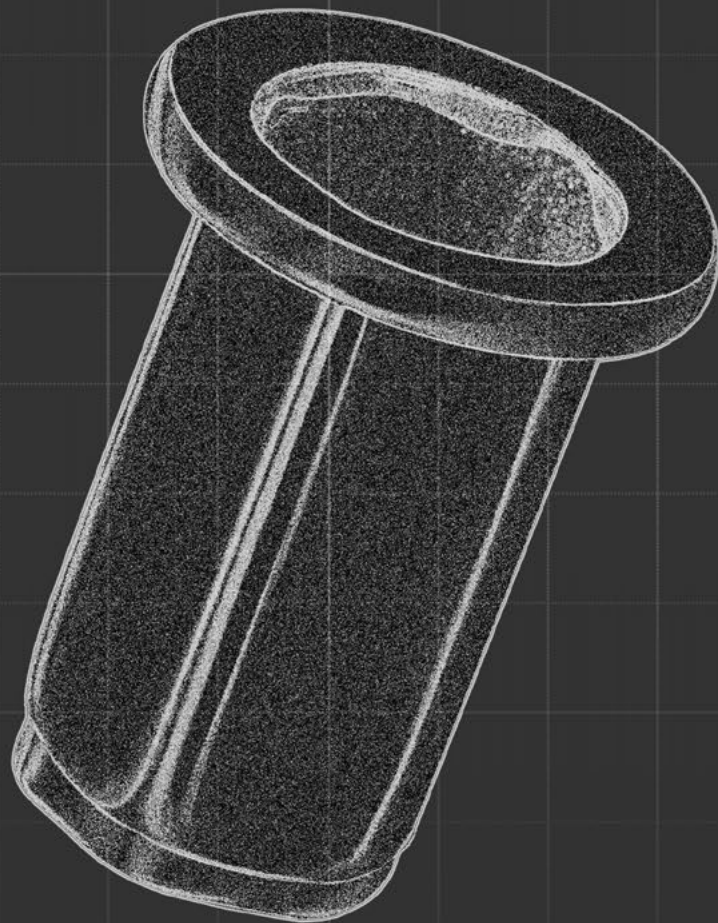

**INSERTI FILETTATI
RIVET NUTS**

INSERTI FILETTATI / RIVET NUTS

I nostri codici sono composti da:

tipo di prodotto, materiale, diametro e lunghezza

Our codes are composed by:

type of product, material, diameter and length

Esempio: **(ATRZ-M8-C-ST)**
Example: (ATRZ-M8-C-ST)
 Tipo di prodotto: **testa ridotta, corpo zigrinato**
Type of product: knurled body reduced head
 Diametro: **M8**
Diameter: M8
 Lunghezza: **corto**
Length: 1° GRIP
 Materiale: **ST - acciaio zincato**
Material: ST - zinc plated

Esempio: **(ATTSE-M4-L-SS)**
Example: (ATTSE-M4-L-SS)
 Tipo di prodotto: **testa tonda, corpo semi esagonale**
Type of product: half hexagonal body dome head
 Diametro: **M4**
Diameter: M4
 Lunghezza: **lungo**
Length: 2° GRIP
 Materiale: **SS - acciaio inox**
Material: SS - stainless steel

A= Awafast

T = testa = head

R = ridotta = reduced

T = tonda = dome

S = svasata = countersank

Z = zigrinato = knurled

E = esagonale = hexagonal

SE = semi esagonale = half hexagonal

C = corto = 1° grip

L = lungo = 2° grip

ST = acciaio zincato = zinc plated

SS = acciaio inox = stainless steel

AL = alluminio = aluminium

Alcuni prodotti hanno particolari condizioni di vendita: tempi di consegna e quantità minima ordinabile.

Some articles have specific sales conditions: such as delivery time and minimum order quantity.

I dati e le caratteristiche presenti in questo catalogo potrebbero variare (es. lunghezza).
The specifics and details in this catalogue could change (i.e. length).

Per qualsiasi ulteriore informazione o chiarimento, siamo a completa disposizione.
For any further information or clarification, don't hesitate to contact us.

ATT

cilindrico testa tonda / cylindrical dome head

ATT

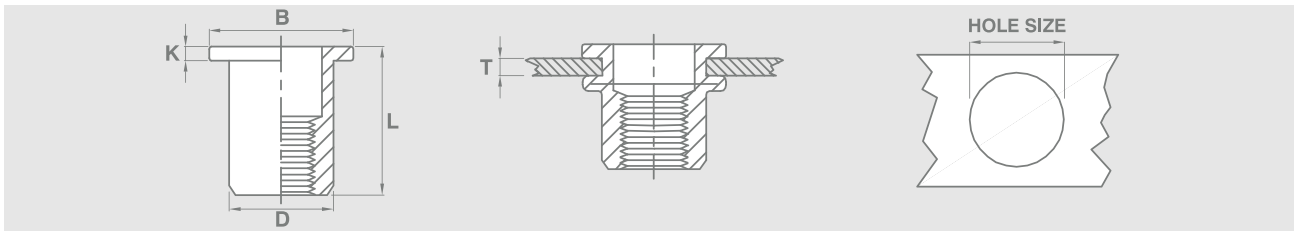

	T (GRIP RANGE) MIN - MAX mm	HOLE SIZE +0.1 mm	D +0.07 -0.1 mm	B mm	K mm	L
M3	0.5 - 1.5	5.0	4.9	7.2	0.8	8.5
	1.5 - 2.5					9.5
M4	0.5 - 2.0	6.0	5.9	8.5	0.8	10.5
	2.0 - 3.5					12.0
M5	0.5 - 2.5	7.0	6.9	10.0	1.0	13.0
	2.5 - 5.0					17.0
M6	0.5 - 3.0	9.0	8.9	12.3	1.3	15.5
	3.0 - 5.5					18.0
M8	0.5 - 3.5	11.0	10.9	15.0	1.5	18.5
	3.5 - 6.0					21.0
M10	1.0 - 3.0	12.0 / 13.0	11.9 / 12.9	17.0	1.6	21.0
	3.0 - 6.0					24.0
M12	1.0 - 4.0	15.0 / 16.0	14.9 / 15.9	18.0	1.7	22.0
	4.0 - 6.5					25.0

specifiche / specifications

ATTC

cilindrico testa tonda cieco / cylindrical dome head closed

ATTC

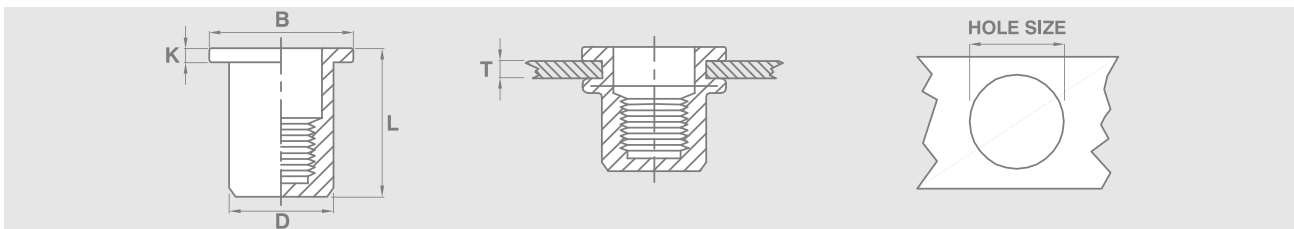

	T (GRIP RANGE) MIN - MAX mm	HOLE SIZE +0.1 mm	D +0.07 -0.1 mm	B mm	K mm	L
M3	0.5 - 1.5	5.0	4.9	7.2	0.8	13.3
M4	0.5 - 2.0	6.0	5.9	9.0	0.8	16.0
	2.0 - 4.0					18.0
M5	0.5 - 2.5	7.0	6.9	10.0	1.0	17.0
	2.5 - 5.0					19.0
M6	0.5 - 3.0	9.0	8.9	12.3	1.3	19.2
	3.0 - 5.5					21.0
M8	0.5 - 3.0	11.0	10.9	15.0	1.5	21.5
	3.0 - 5.5					24.0
M10	1.0 - 4.0	12.0 / 13.0	11.9 / 12.9	17.0	1.6	27.0

specifiche / specifications

INSERTI FILETTATI / RIVET NUTS

cilindrico testa ridotta / cylindrical reduced head

ATR

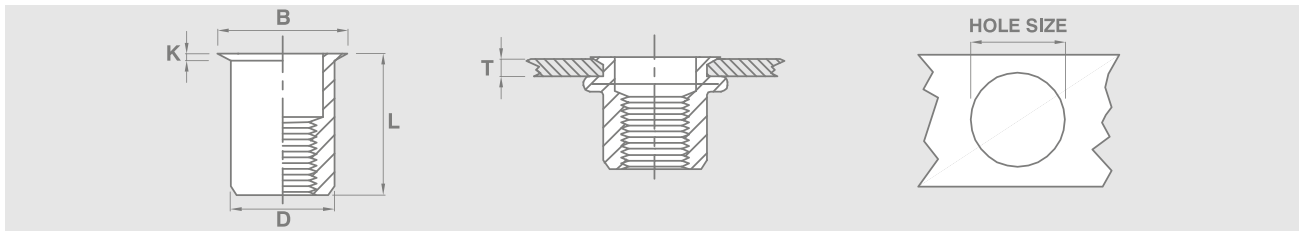

	T (GRIP RANGE) MIN - MAX mm	HOLE SIZE +0.1 mm	D +0.07 -0.1 mm	B mm	K mm	L
M3	0.5 - 1.5	5.0	4.9	6.0	0.5	9.0
M4	0.5 - 2.0	6.0	5.9	7.0	0.5	10.5
	2.0 - 4.0					13.0
M5	0.5 - 2.0	7.0	6.9	8.0	0.5	11.5
	2.0 - 4.0					13.0
M6	0.5 - 2.5	9.0	8.9	10.5	0.6	14.0
	2.5 - 5.0				0.6	17.0
M8	0.5 - 3.0	11.0	10.9	12.0	0.65	16.5
	3.0 - 5.0					18.5
M10	0.5 - 3.0	12.0 / 13.0	11.9 / 12.9	14.1	0.7	17.7
	3.0 - 5.5					21.0
M12	1.0 - 4.0	15.0 / 16.0	14.9 / 15.9	17.6	0.75	24.2

specifiche / specifications

ATRC

cilindrico testa ridotta cieco / cylindrical reduced head closed

ATRC

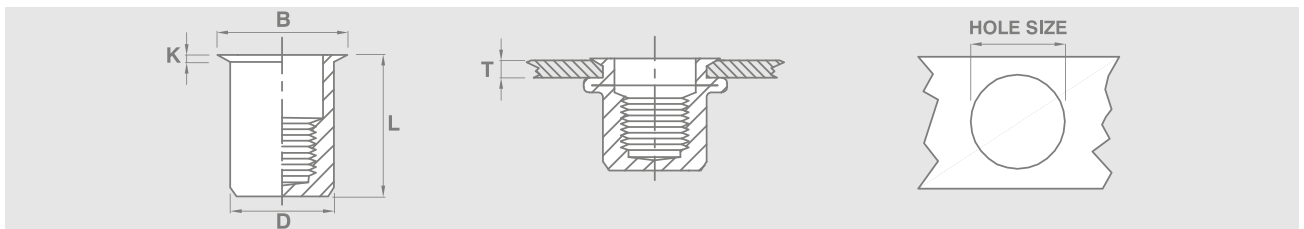

	T (GRIP RANGE) MIN - MAX mm	HOLE SIZE +0.1 mm	D +0.07 -0.1 mm	B mm	K mm	L
M4	0.5 - 2.0	6.0	5.9	7.0	0.5	15.0
	2.0 - 3.5					16.0
M5	0.5 - 2.0	7.0	6.9	8.0	0.5	16.5
	2.0 - 3.5					17.5
M6	0.5 - 2.5	9.0	8.9	10.0	0.6	20.5
	2.5 - 4.0				22.0	
M8	0.5 - 3.0	11.0	10.9	12.0	0.65	23.0
	2.5 - 4.5					24.5
M10	1.0 - 3.0	12.0 / 13.0	11.9 / 12.9	14.1	0.7	24.5
	3.0 - 5.0					26.0

specifiche / specifications

ATTZ

zigrinato testa tonda / knurled dome head

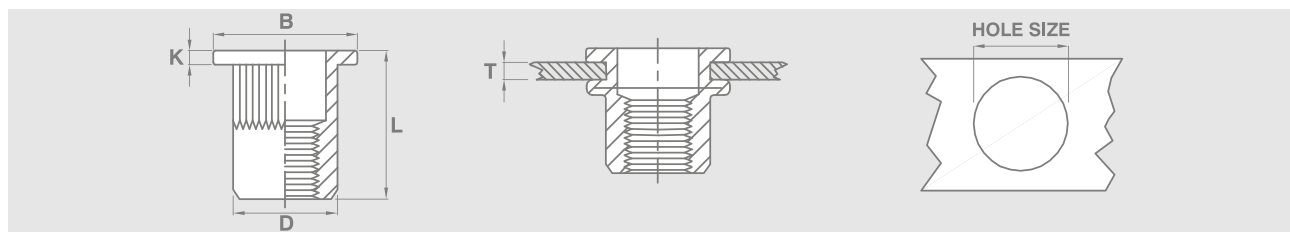

	T (GRIP RANGE) MIN - MAX mm	HOLE SIZE +0.1 mm	D +0.07 -0.1 mm	B mm	K mm	L
M3	0.5 - 1.5	5.0	4.9	8.0	0.8	10.0
M4	0.5 - 2.0	6.0	5.9	9.0	0.8	10.5
	2.0 - 3.5					12.0
M5	0.5 - 2.5	7.0	6.9	10.0	1.0	13.0
	2.0 - 5.0					16.5
M6	0.5 - 3.0	9.0	8.9	12.30 (*13.0)	1.3	15.5
	3.0 - 5.5					19.5
M8	1.0 - 3.5	11.0	10.9	14.5 (*16.0)	1.5	18.5
	3.5 - 6.0					21.0
M10	1.0 - 4.0	12.0 / 13.0	11.9 / 12.9	17.0 (*19.0)	1.7	21.5
	4.0 - 6.5					24.0
M12	1.0 - 4.0	15.0 / 16.0	14.9 / 15.9	18.0	1.7	22.0
	4.0 - 6.5					25.0

ATTZC

zigrinato testa tonda cieco / knurled dome head closed

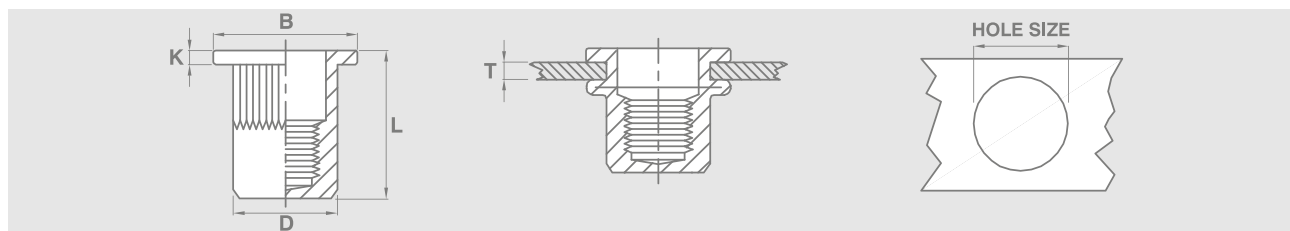

	T (GRIP RANGE) MIN - MAX mm	HOLE SIZE +0.1 mm	D +0.07 -0.1 mm	B mm	K mm	L
M4	0.5 - 2.0	6.0	5.9	9.0	0.8	16.0
	2.0 - 4.0					18.0
M5	0.5 - 3.0	7.0	6.9	10.0	1.0	17.0
	2.5 - 5.0					19.0
M6	0.5 - 3.0	9.0	8.9	12.30	1.3	19.2
	3.0 - 5.0					21.0
M8	0.5 - 3.0	11.0	10.9	15.0	1.5	21.5
	3.0 - 5.5					24.0
M10	1.0 - 4.0	12.0 / 13.0	11.9 / 12.9	17.0	1.6	27.0

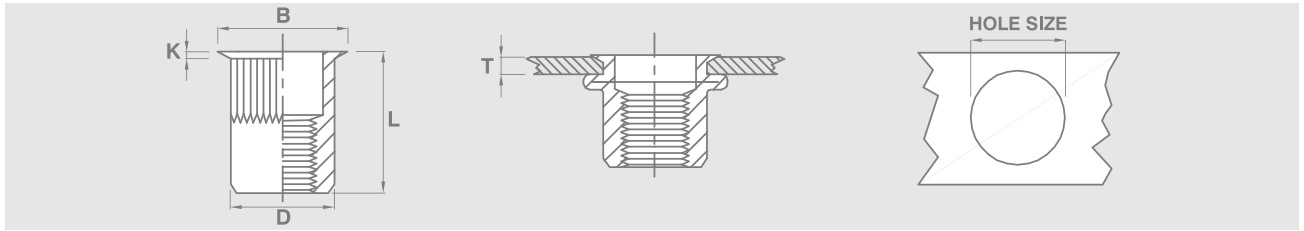

	T (GRIP RANGE) MIN - MAX mm	HOLE SIZE +0.1 mm	D +0.07 -0.1 mm	B mm	K mm	L
M3	0.5 - 2.0	5.0	4.9	6.0	0.5	9.0
M4	0.5 - 2.0	6.0	5.9	7.0	0.5	11.2
	2.0 - 4.0					13.0
M5	0.5 - 2.0	7.0	6.9	8.0	0.5	11.5
	2.0 - 4.0					13.0
M6	0.5 - 2.5	9.0	8.9	10.0	0.6	14.0
	2.5 - 5.0					16.0
M8	0.5 - 3.0	11.0	10.9	12.0	0.65	16.5
	3.0 - 5.0					18.5
M10	1.0 - 3.5	12.0 / 13.0	11.9 / 12.9	14.0	0.7	19.5
	3.5 - 6.0					22.0
M12	1.0 - 4.0	15.0 / 16.0	14.9 / 15.9	17.6	0.75	24.2

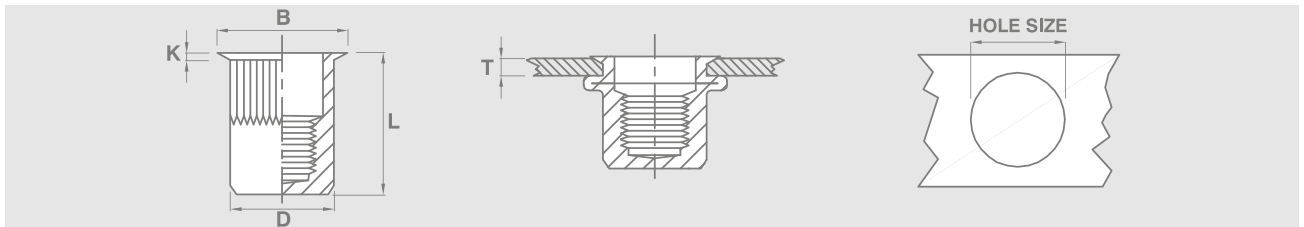

	T (GRIP RANGE) MIN - MAX mm	HOLE SIZE +0.1 mm	D +0.07 -0.1 mm	B mm	K mm	L
M4	0.5 - 2.0	6.0	5.9	7.0	0.5	15.0
	2.0 - 3.5					16.5
M5	0.5 - 2.0	7.0	6.9	8.0	0.5	16.5
	2.0 - 3.5					18.0
M6	0.5 - 3.0	9.0	8.9	10.0	0.6	20.5
	3.0 - 4.5					22.0
M8	0.5 - 3.0	11.0	10.9	12.0	0.65	23.0
	3.0 - 4.5					24.5
M10	1.0 - 3.0	12.0 / 13.0	11.9 / 12.9	14.0	0.7	24.5
	3.0 - 5.0					26.0

ATTE

esagonale testa tonda / hexagonal dome head

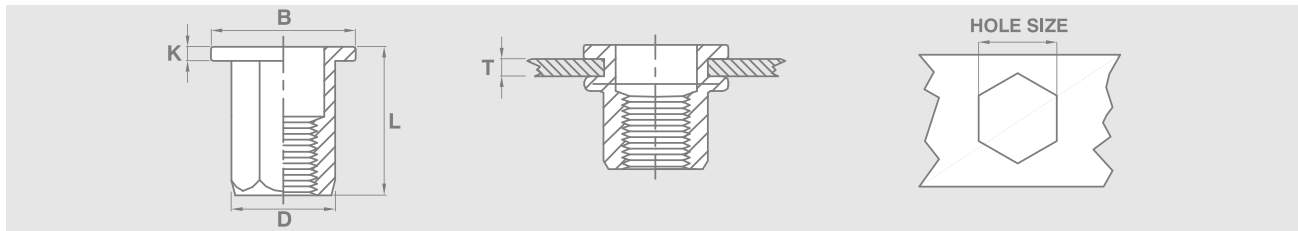

	T (GRIP RANGE) MIN - MAX mm	HOLE SIZE +0.1 mm	D +0.07 -0.1 mm	B mm	K mm	L
M4	0.5 - 2.0	6.0	5.9	9.0	0.8	11.0
M5	0.5 - 2.5	7.0	6.9	10.0	1.0	14.0
M6	0.5 - 3.0	9.0	8.9	12.7 (*13.0)	1.35	15.0 (*16.0)
M8	1.0 - 3.5	11.0	10.9	16.0	1.5	18.0
M10	1.0 - 3.5	12.0 / 13.0	11.9 / 12.9	18.0 (*19.0)	1.7	21.0 (*23.0)
M12	1.0 - 4.0	15.0 / 16.0	14.9 / 15.9	20.0	1.7	23.0

ATTEC

esagonale testa tonda cieco / hexagonal dome head closed

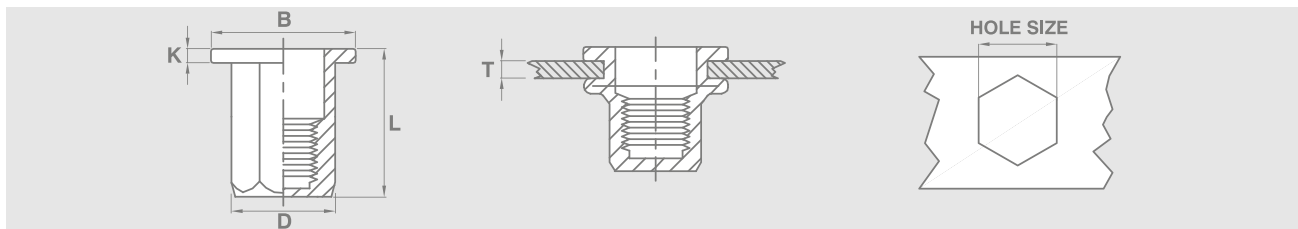

	T (GRIP RANGE) MIN - MAX mm	HOLE SIZE +0.1 mm	D +0.07 -0.1 mm	B mm	K mm	L
M4	0.5 - 2.0	6.0	5.9	9.0	1.0	15.0
M5	0.5 - 2.5	7.0	6.9	10.0	1.0	18.0
M6	0.5 - 3.0	9.0	8.9	12.7	1.5	23.0
M8	1.0 - 3.5	11.0	10.9	16.0	1.5	26.0
M10	1.0 - 4.0	12.0 / 13.0	11.9 / 12.9	19.0	2.0	33.0

INSERTI FILETTATI / RIVET NUTS

esagonale testa ridotta / hexagonal reduced head

ATRE

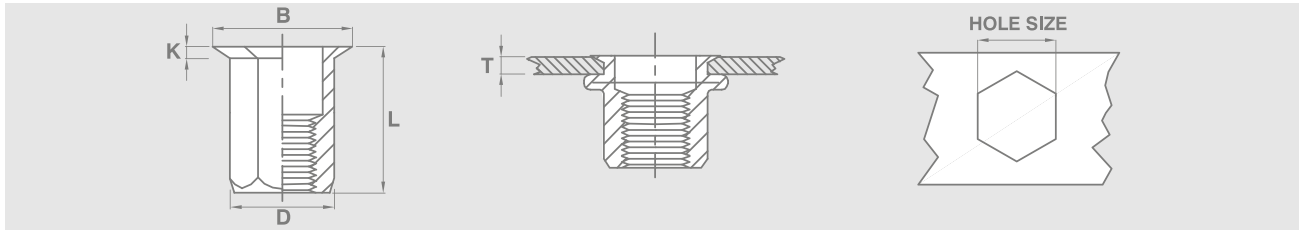

	T (GRIP RANGE) MIN - MAX mm	HOLE SIZE +0.1 mm	D +0.07 -0.1 mm	B mm	K mm	L
M4	0.5 - 2.5	6.0	5.9	7.0	0.5	11.0
	2.5 - 5.0					13.5
M5	0.5 - 3.0	7.0	6.9	8.0	0.5	14.5
	3.0 - 5.0					16.0
M6	1.0 - 3.5	9.0	8.9	10.0	0.6	16.0
	3.5 - 6.0					18.0
M8	1.0 - 4.0	11.0	10.9	12.0	0.65	18.0
	4.0 - 6.0					20.0
M10	1.0 - 3.5	12.0 / 13.0	11.9 / 12.9	14.5	0.75	19.0
	3.5 - 6.0					23.5

specifiche / specifications

ATREC

esagonale testa ridotta cieco / hexagonal reduced head closed

ATREC

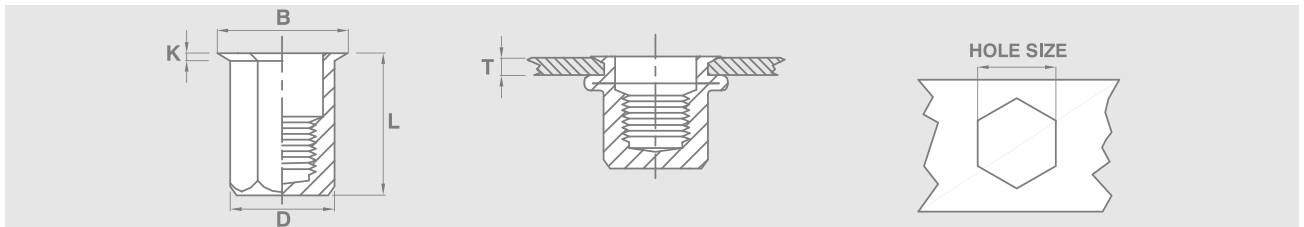

	T (GRIP RANGE) MIN - MAX mm	HOLE SIZE +0.1 mm	D +0.07 -0.1 mm	B mm	K mm	L
M4	0.5 - 2.5	6.0	5.9	7.0	0.5	16.0
M5	0.5 - 3.0	7.0	6.9	8.0	0.5	20.0
M6	0.5 - 3.5	9.0	8.9	10.0	0.6	20.5
M8	1.0 - 4.0	11.0	10.9	12.0	0.65	23.0
M10	1.0 - 4.0	12.0 / 13.0	11.9 / 12.9	14.5	0.75	28.5

specifiche / specifications

ATTSE

semiesagonale testa tonda / half hexagonal dome head

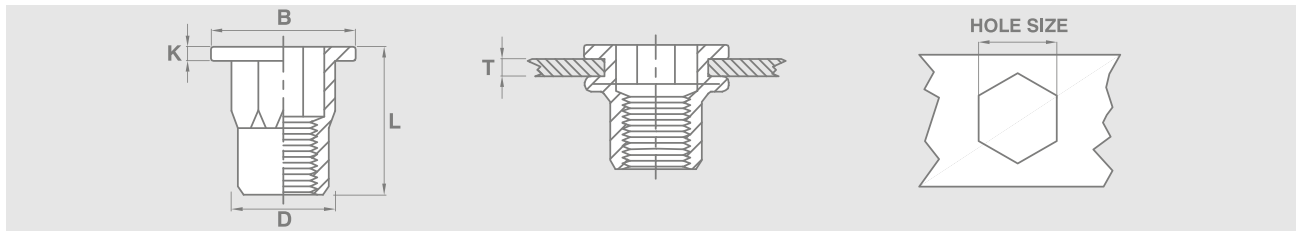

	T (GRIP RANGE) MIN - MAX mm	HOLE SIZE +0.1 mm	D +0.07 -0.1 mm	B mm	K mm	L
M4	0.5 - 2.0	6.0	5.9	9.0	0.8	11.0
M5	0.5 - 2.5	7.0	6.9	10.0	1.0	13.0
M6	0.5 - 3.0	9.0	8.9	12.7	1.35	15.0
M8	1.0 - 3.5	11.0	10.9	16.0	1.5	18.0
M10	1.0 - 3.5	12.0 / 13.0	11.9 / 12.9	18.0	1.7	21.0
M12	1.0 - 4.0	15.0 / 16.0	14.9 / 15.9	20.0	1.7	23.0

ATTSE

specifiche / specifications

ATTSEC

semiesagonale testa tonda cieco / half hexagonal dome head closed

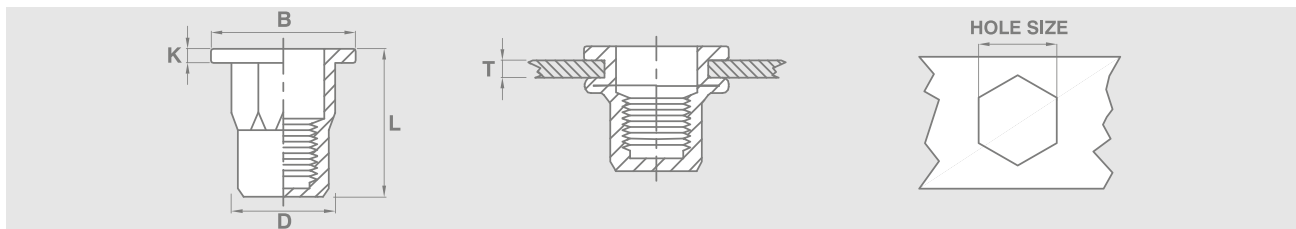

	T (GRIP RANGE) MIN - MAX mm	HOLE SIZE +0.1 mm	D +0.07 -0.1 mm	B mm	K mm	L
M4	0.5 - 2.0	6.0	5.9	9.0	0.8	15.0
M5	0.5 - 2.5	7.0	6.9	10.0	1.0	18.0
M6	0.5 - 3.0	9.0	8.9	12.7	1.35	23.0
M8	1.0 - 3.5	11.0	10.9	16.0	1.5	26.0
M10	1.0 - 4.0	12.0 / 13.0	11.9 / 12.9	19.0	1.7	33.0

ATTSEC

specifiche / specifications

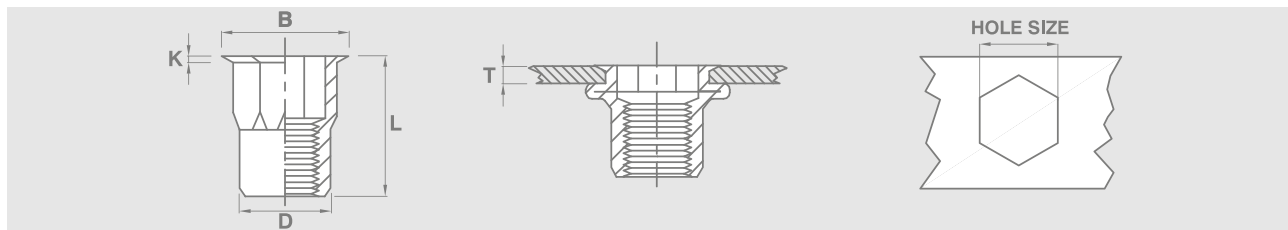

	T (GRIP RANGE) MIN - MAX mm	HOLE SIZE +0.1 mm	D +0.07 -0.1 mm	B mm	K mm	L
M4	0.5 - 2.0	6.0	5.9	7.0	0.5	12.0
M5	0.5 - 2.5	7.0	6.9	8.0	0.5	13.0
M6	1.0 - 3.5	9.0	8.9	10.0	0.6	16.0
M8	1.0 - 3.5	11.0	10.9	12.0	0.65	17.5
M10	1.0 - 4.0	12.0 / 13.0	11.9 / 12.9	14.5	0.75	21.0

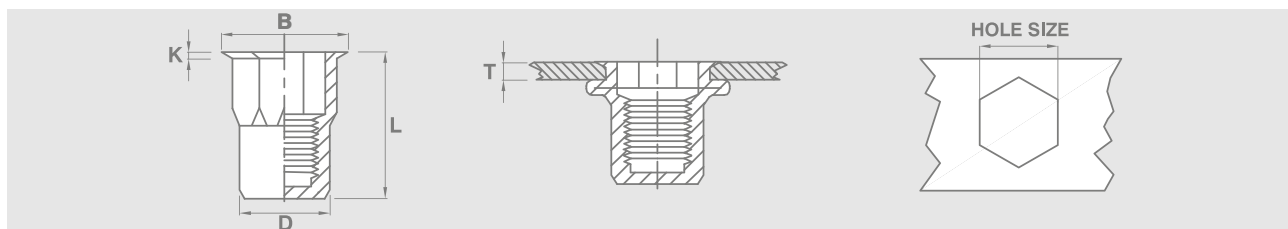

	T (GRIP RANGE) MIN - MAX mm	HOLE SIZE +0.1 mm	D +0.07 -0.1 mm	B mm	K mm	L
M4	0.5 - 2.0	6.0	5.9	7.0	0.5	15.5
M5	0.5 - 2.5	7.0	6.9	8.0	0.5	18.0
M6	0.5 - 3.5	9.0	8.9	10.0	0.6	21.5
M8	1.0 - 3.5	11.0	10.9	12.0	0.65	24.0
M10	1.0 - 4.0	12.0 / 13.0	11.9 / 12.9	14.5	0.75	30.5

ATS

testa svasata / countersunk head

ATS

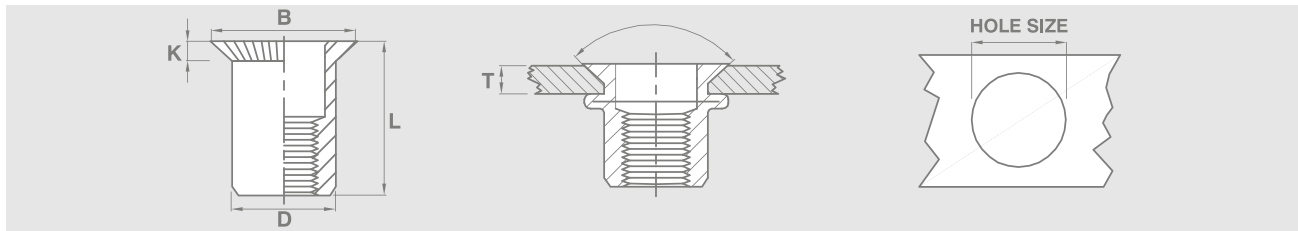

	T (GRIP RANGE) MIN - MAX mm	HOLE SIZE +0.1 mm	D +0.07 -0.1 mm	B mm	K mm	L
M4	1.5 - 3.0	6.0	5.9	9.0	1.5	12.0
M5	1.5 - 3.5	7.0	6.9	10.0	1.5	13.0
M6	1.5 - 4.0	9.0	8.9	12.0	1.5	15.5
M8	2.0 - 4.5	11.0	10.9	14.0	1.5	18.5
M10	2.0 - 5.0	12.0 / 13.0	11.9 / 12.9	16.0	1.5	21.0

specifiche / specifications

ATSZ

zigrinato testa svasata / knurled countersunk head

ATSZ

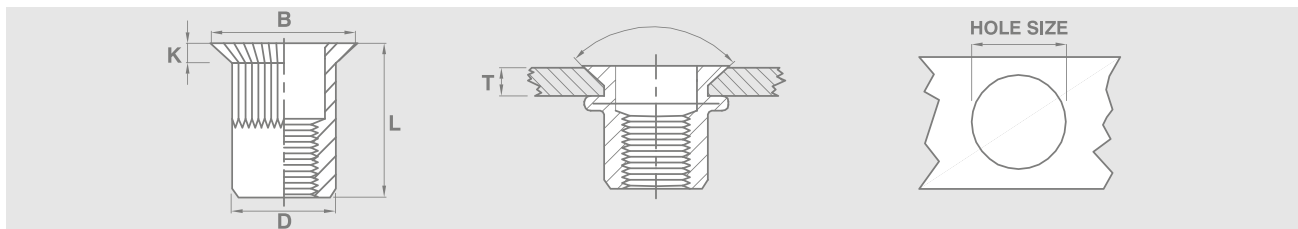

	T (GRIP RANGE) MIN - MAX mm	HOLE SIZE +0.1 mm	D +0.07 -0.1 mm	B mm	K mm	L
M4	1.5 - 3.0	6.0	5.9	9.0	1.5	12.0
M5	1.5 - 3.5	7.0	6.9	10.0	1.5	13.0
M6	1.5 - 4.0	9.0	8.9	12.0	1.5	15.5
M8	2.0 - 4.5	11.0	10.9	14.0	1.5	18.5
M10	2.0 - 5.0	12.0 / 13.0	11.9 / 12.9	16.0	1.5	21.0
M12	2.0 - 5.0	15.0 / 16.0	14.9 / 15.9	19.0	1.5	24.0

specifiche / specifications



AWAFast SRL

via baranzate 89, 20026 novate milanese (mi) | C.F. e P. IVA 09680300960

ph. + 39 02 366 35 791 | fax + 39 02 366 35 790

info@awafast.com | www.awafast.com